

# CNP-5300D

## IS Digital Positioning system camera 36x



### Product Features

- 2MP, 36X built-in
- Pan 360 degrees / Tilt -90 degrees to 40 degrees wide monitoring is possible
- Basic installation of wiper / heater (\*IR, Laser emitter optional)
- Fireproof, flameproof coating possible / Front glass anti-contamination coating function
- Multi-protocol automatic support, RS-485/422

### Exterior drawing

UNIT(mm)

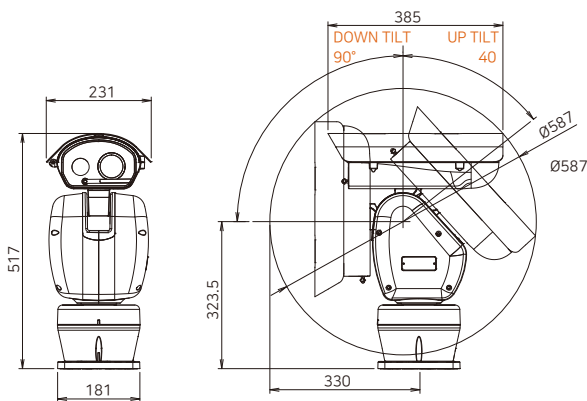

### Accessory

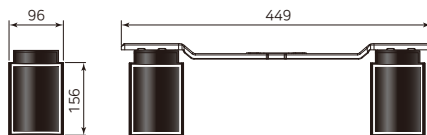

Front 2D View

Ex) Ass'y Light Bracket

#### IR Illuminator : SPI-50

Max distance Number LEDs	200m (12ea)
Light Angle Range	Fixed Lens 15°
Auto adjustment function	Auto IR On/Off, Day & Night
Dustproof/Waterproof/Standard	IP66 / CE, FCC, KC / IK10
Power supply	12V DC(±10%) / 2A (2ea)

### Specification

#### CAMERA

Image Sensor	1/2", 2M IMX 385 SONY STARVIS SENSOR
maximum Pixels	1,952(H)x1,113(V)2.17M
Min illumination Color	Color(1/30s) : 0.15 lux, Color DSS(1/7.5s) : 0.0375 lux,
Min illumination B/W	BW(1/30s) : 0.001 lux, BW(1/7.5s) : 0.002 lux
Scanning System/S/N Ratio	Progressive / 55db
Video Output	HD:LVDS,EX-SDI Analog SD : VBS(without WDR)

#### LENS

Lens Type / Zoom	Optical x36, Digital x16 Zoom
Focal Length	f = 6.0 mm ~ 216.0 mm / F1.5 (wide) ~ F4.8 (tele)
Angle of View	H:56.5 ° V:36 °

#### CAMERA FUNCTION

Day & Night	Auto/Day/Night/Ext-in
WDR/BLC	Off/WDR/BLC
ELC	Automatic: Min. 1/135,000 sec ~ Max. 1/60 sec
DNR	Auto/Off/Low/Middle/High
Defog	Off/On(Auto/Manual)
Motion Detection	Off/On(4 positions)
Privacy mask	Off/On(8 positions)
White balance	Auto/One push/Manual/Indoor/Outdoor

#### NETWORK

Ethernet	10/100BASE-T Ethernet Auto sensing
Video compression	H264, H265, Motion JPEG
Resolution	1920X1080, 1280X760, 640x480, 352X288, 320X240 ETC
transmission capability	Motion JPEG and H.264 Triple Streaming (Simultaneously)
Audio In/Out	Sampling rates 8KHz, 16bit, Mono Audio, 1ch in&1ch out
Audio compression	Two way(G.711)
Audio communication	Two way
Protocol	HTTP, RTP/RTSP(Uni/Multicast), TCP/IP(v4/v6), UDP, FTP, Telnet, HTTPS, SNMP, DHCP, NTP, SMTPclient, uPnP & etc
Max. user access	Live-cast for up to 10 clients
Security	Multi user level protection for camera access, PTZ, Alarm I/O

#### GENERAL

Pan Range / Speed	0° ~ 360° (Endless), 0.025°/sec ~ 120°/sec
Tilt Range / Speed	-90° ~ 40°, 0.025°/sec ~ 40°/sec
Preset Accuracy / Repeat	Max. ±0.1° / Max. ±0.05°
Preset / Speed	Max. 319 Point / Max. 120°/sec(Pan)
Scan / Group / Pattern	8 / 6 / 4
Fan / Heater / Wiper	Built-in Fan / Heater / Defrost Heater / Wiper
Power Source	AC 24V ±10%, 6A(MAX)
Power Consumption	100W (Heater on), 38W (Heater off)
Operating Temperature	-40°C ~ 55°C (-40°F ~ 131°F) / Up to 90%RH
Unit Dim / Usable Dim	W x H x D(mm): 219 x 510 x 530 / 154 x 112 x 296.5
Unit / Load Weight	Product : 11kg / Load(Max 7kg)
Color/material	White / Aluminum die-casting
Certificate/IP Rating	IP 66, KC, CE

※ Design and Specification can be different between latest production, Please contact out sales for update.

# ASP POSITIONING CCTV Camera series



## CNP-5300D

IS Digital Positioning system camera

### Product Features

- 2MP, 36X built-in
- Pan 360 degrees / Tilt -90 degrees to 40 degrees wide monitoring is possible
- Basic installation of wiper / heater (\*IR, Laser emitter optional)
- Fireproof, flameproof coating possible / Front glass anti-contamination coating function
- Multi-protocol automatic support, RS-485/422

